

AWESOMENESS *is in our* NATURE.

CROSS
CREEK
RANCH



CROSSCREEKTEXAS.COM



35 FOOTBALL FIELDS

That is roughly the size of Cross Creek's majestic Polishing Pond, a great place to catch a stunning sunset or cheer on the flocks of migratory birds that visit each year.

34 MILES

That's how far you can see from the Observation Tower. On a clear day you can even get a glimpse of Williams Tower in the Galleria.



PRETTY SLICK!

The Adventure Island waterpark slide is **140 feet long**.

28+ MILES

of Hike and Bike Trails make wandering around the community a truly wonderful thing.

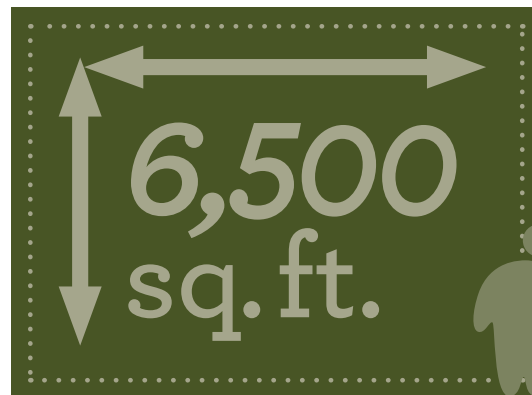

OF GYM SPACE

WATER IN CCR LAKES COULD FILL



3.3

ASTRODOMES

Schools earn an

22% of teachers in the Lamar CISD and

25% in Katy ISD hold advanced degrees.

42% in both districts have more than 10 years of experience.

AWESOMENESS *is in our* NATURE.

CROSS
CREEK
RANCH



CROSSCREEKTEXAS.COM



FLEWELLEN CREEK PARK

This 150 acres of natural splendor is one of the few creeks in the Katy area, and the only one that will be fully restored

NEARLY 50
SPECIES OF BIRDS

call CCR home throughout the year



OVER
55,000
TREES

have been planted at CCR



KIDS CAN
BIKE TO
SCHOOL

32+
POCKET
PARKS &
PLAYGROUNDS



RECLAIMED
WATER

is used for over 95% of community irrigation needs



EVENTS
EACH
YEAR

Casino nights to kayaking, the Cross Creek Ranch calendar is filled with fun and exciting events thanks to our onsite Lifestyle Director.